



HS-007 Pro

User Guide

Contents

03	HS-007 Pro Basics
04	HS-007 Pro at a glance
05	Using HS-007 Pro controls
06	Recharging the battery
07	HS-007 Pro Accessory
09	Instructions for use
09	To detect the wireless tapping signals
12	Guard Mode (Sound /Vibrate Mode)
13	Safety and Handling
15	Preventing the hearing damaged
16	Important handling information

HS-007 Pro Basics

1

Please read this chapter carefully to know about more information about the function and operation on HS-007 Pro.

Use HS-007 Pro to:

- Business negotiation or contract signed.
- Check the suspicious wireless camera in the restaurants, hotels, Toilets,swimming ponds, or dressing rooms, etc.
- Protect confidentiality in military units or government agencies.
- Avoid being photographed in companies, factories, cinema or art galleries, etc.
- Protection for privacy in some private places(such as at home).

HS-007 Pro at a glance

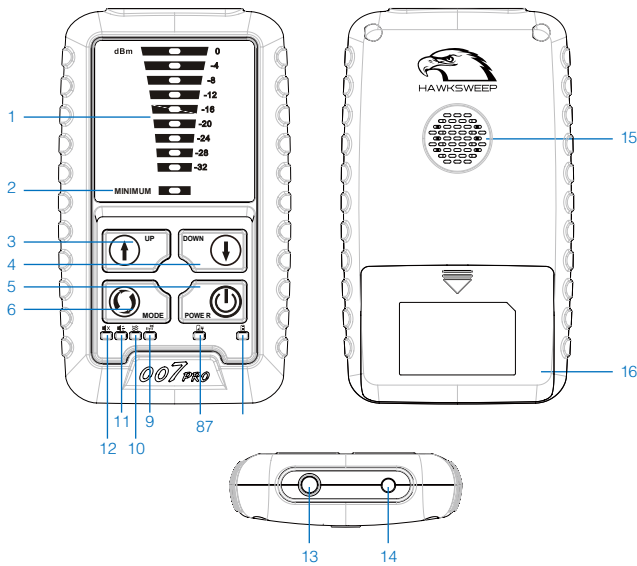

- | | |
|-------------------------------|---------------------------------|
| 1. Signal Strength Indication | 9. Cellphone Locking LED Lights |
| 2. Minimum Indication Lights | 10. Acoustic Mode Light |
| 3. Increase sensitivity | 11. Sound Mode Light |
| 4. Decrease sensitivity | 12. Silent Mode Light |
| 5. Power ON/OFF | 13. Headphone Jack |
| 6. Selectable Mode Button | 14. Recharging Connector |
| 7. Power LED Lights | 15. Speaker |
| 8. Charging LED lights. | 16. Battery Cover |

Using HS-007 Pro controls

Operate the device buttons and enter the desirable modes.

To	Do this	Model light
ON/OFF	Keep pressing Power Buttons for 2 seconds	
Increase sensitivity	Press UP	
Decrease sensitivity	Press DOWN	
Silent Mode	Press Mode ,the corresponding lights will be on.	
Sound Mode	Press Mode ,the corresponding lights will be on.	
Acoustic Mode	Press Mode ,the corresponding lights will be on.	
Guard Mode	Press Mode to make the lights on shown as picture.	
Vibrate Mode	Press Mode to make the lights on shown as picture.	

Recharging the battery

HS-007 Pro kit comes with a rechargeable battery.

To prolong the battery lifespan, please make a full recharge for the battery for the first time.

It takes around 2 hours to finish the recharging. In case of long time not used, HS-007 Pro need to be recharged.

Take use of AC adapter to recharge for the inside battery.

1. Put USB connector to AC adapter.
2. Plug the AC adapter into the power outlet.
3. Plug DC connector into HS-007 Pro power connector.

Computer USB Connector can also be used to recharge HS-007 Pro.

Recharging : Red lights is on. Full charged : Blue light is on.

HS-007 Pro Accessory

HS-007 Pro kit accessoried with one headset and power adapter.

Headset

HS-007 Pro is accessoried with a high quality volume adjustable headset.

Power adapter

HS-007 Pro also comes with a 5V/1A power adapter.

Instructions for use

2

To detect the wireless tapping signals

Silent/Sound/Acoustic Mode

Before the detection, please try to turn off all the wireless equipments(such as wireless router,cellphone and computer,etc) to make sure the indoor signal strength to the minimum level and get a more precise detecting effect , avoid wrong detection or location guiding.

Select the modes (Silent/Sound/Acoustic).

Before the detection, we need to adjust HS-007 Pro sensitivity through UP/Down Button to make sure the signal strength lights is not higher than MINIMUM.

Try to move HS-007 Pro close to the places that are easier to put the tapping and listening device or hidden cameras, such as air vents,Decorative molding, heating radiator, cabinet, electrical

equipment, clocks,watches, flower vase, etc.

Once HS-007 Pro find the radiation equipments, the signal strength lights will be increased accompanied with the increasing radiation level. When the signal strength lights to be the maximum, Press DOWN to lower the signal strength.This will be more accurate to locate the radiation source. Repeat such operation until the signal strength level not changed,double check the position, and finally you can locate the wireless tapping , listening devices,etc.

Acoustic Mode ,You can search by the sound.

HS-007 Pro can differentiate the position of signal source by its radiated sounds, so you can detect those innocent and not obvious radiation signals in your local. HS-007 Pro will make the sounds and inform where the signal source is. This mode can also demodulate the acoustic signals. You can identify whether radiation equipments are on by the sound.If more radiation equipments are switched on,you can also discern them.

For Sound Mode and Acoustic Mode, you can use the headset. You just plug the headset into HS-007 Pro the build-in speaker will be closed automatically. Whenever in quiet or noisy environment you can search the radiation source through this headphone.

Please do not make confusion on the headset connector and recharging connectors to avoid the damage of the device.

Guard Mode (Sound /Vibrate Mode)

This mode is generally used to ensure security during the meeting, confidential information avoid being leaked to third parties.

To select Guard Mode (Sound/Vibrate Mode).

When it is activated, HS-007 Pro will monitor the change of signal strength level. Once the radiation level is beyond the safety range. HS-007 Pro will make sound or vibrate to alarm you.

Safety and Handling

3

This chapter includes some important safety issues and operational information. To avoid damage of HS-007Pro, please read the above carefully.



Warning: Failure to follow up these safety instructions may lead to fire, electric shock or others injury or damage.

Please do not bend, throw, squeeze, puncturing, flaming or even open the case of HS-007 Pro while using.

Avoid putting in water or wet places. Do not use in the raining, near washbasin or others damp places. Please do not spill any food or liquid on the device, if did, please open battery case and take out of the battery immediately, you can restart the device after it is thoroughly dried.

To repair HS-007 Pro, do not try to repair it by yourself. This device

does not come with any components to be repaired by the users. Any repairing information, please contact the factory or your local distributors.

To recharge HS-007 Pro, please make sure power adapter connects well and then plug into power outlet. Please do not touch the power adapter with wet hands.

Please do not use other brand power adapter to recharge HS-007 Pro, only the supplied one.

It is normal there will be some heat for the power adapter. Please try to be ventilated and operated cautiously.

In case of any of the below happened, please pull out this power adapter.

- Power Cable or Plug worn or damaged.
- Exposed to the rain or over damp.
- Its case has been damaged.
- You find the power adapter needs repairing, please repair it in time.
- You want to clean the adapter.

Preventing the hearing damaged

It may lead to permanent hearing damage if you tune the volume too high while using the headset or headphone.

Hearing experts advise the following methods to protect your hearing:

- Limit the time to wear headset or headphone under a high volume.
- Avoid tuning high volume to isolate the noisy environment.
- Please tune a low volume if you could not hear others.

Important handling information

Failure to follow up these operational instructions may lead to the device or other properties.

Carry HS-007 Pro HS-007 Pro Contains sensitive components.Do not bend, throw or squeeze.

Never force the connector into the port , check whether the port is blocked. if the connector can not be inserted into the port easily , It means they probably are not matched. Make sure they are matched, and their angle position are corresponding.

Please use HS-007 Pro under the sustainable temperature range around 0°~35°C(32°to 95°F).

Please put away HS-007 Pro between -20°to 45°C(-4°to 113°F). Do not leave HS-007 Pro in the car.The temperature in the car will exceed this temperature range while it is parking.

It is normal that HS-007 Pro will be hot while you use it or charge it. The case of HS-007 Pro disperse the heat from the device inside automatically.

Please keep HS-007Pro surface clean.Turn off the device before cleaning. Try to use a soft , moist and lint-free cloth to wipe its surface.Avoid getting moisture from the openings. Never use rubbing

painting , household cleaners, chemical spray, solvents , alcohol, ammonia , or abrasives.